

# LED MICRODASH

HIGH INTENSITY LED WARNING SIGNAL



## ELECTRICAL SPECIFICATIONS:

**Input Voltage:** 10 to 16 Vdc.  
**Current Drain:** 0.25 Amps Max.

## INSTALL MOUNTING BRACKETS:

The mounting location will determine the type of bracket used. A WINDOW BRACKET is provided for mounting directly to the windshield. A Standard bracket is included for mounting on dash or rear deck. The LED MICRODASH may also be mounted without a bracket by using the supplied velcro discs.



Install the bracket using the supplied hardware shown in photo.

**NOTE:** If you are using velcro to mount the LED MICRODASH you must install the screws and washers to hold the flashback shield in place.



## WINDOW MOUNTING:

Choose the mounting location on windshield. The WINDOW BRACKET can be bent to allow for various windshield angles.

**Clean the surface of the windshield with alcohol to ensure a proper bond.** Peel the red backing strip off of the adhesive tape which is pre-mounted to the bracket. Press firmly against windshield and hold for 5 seconds. The adhesive is 3M® VHB tape and provides an extremely strong bond to the windshield.



## BRACKET MOUNTING:

The standard bracket can be used to mount the LED MICRODASH in a variety of locations.

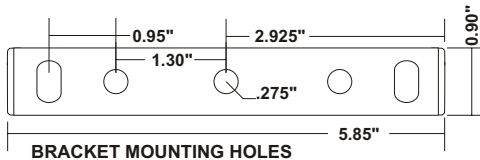

## VELCRO MOUNT:

**Clean the surface of the LED MICRODASH and the mounting surface with alcohol before applying velcro discs.** Apply the velcro discs to the LED MICRODASH and the mounting surface.

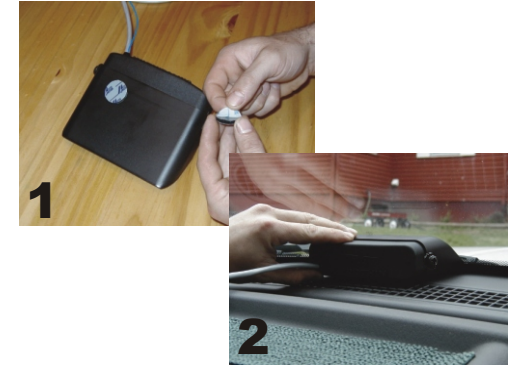

**TIP:** For correct alignment, press the hook and loop velcro discs together and adhere to the LED MICRODASH first. Then put the LED MICRODASH into the mounting position and press down against surface.

## ELECTRICAL CONNECTION:

The LED MICRODASH has an 8 foot cable with a standard cigarette lighter plug.

PLUG CONTAINS A REPLACEABLE FUSE. 5 AMP TYPE 3AG FUSE.



**FUSE REMOVAL:** PUSH TIP IN AND TURN COUNTERCLOCKWISE, THEN PULL TIP AND FUSE OUT.

## FLASH PATTERN SELECTION:

The LED MICRODASH comes factory set to Pattern 12 (Random). The Flash pattern can be changed by pressing the PUSH-BUTTON located on the back of the unit. The flash pattern will increment by 1 each time and loop back around to pattern 1 when incremented past 12.

The LED MICRODASH will remember the flash pattern you select even when disconnected from power.

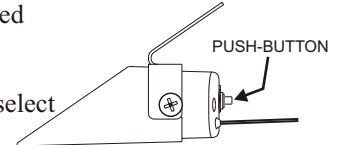

#	Flash Pattern	Description
1	Steady On	All 4 LEDs constant on. May be used with external 12V flasher.
2	Double (split)	2 Flash Bursts, Split 2-2
3	Quad (split)	4 Flash Bursts, Split 2-2
4	Mega (split)	Single Flashes, High Rate, Split 2-2
5	DeciBlast (split)	10 Flash Bursts, Split 2-2
6	Double (all)	2 Flash Bursts, All 4 LEDs light at the same time.
7	Quad (all)	4 Flash Bursts, All 4 LEDs light at the same time.
8	Mega (all)	Single Flashes, High Rate, All 4 LEDs light at the same time.
9	DeciBlast (all)	10 Flash Bursts, All 4 LEDs light at the same time.
10	Flasher	Wig-Wag, 3 Flashes per second, Split 2-2
11	California	Left 2 LEDs Flashing, Right 2 LEDs Steady On.
12	Random, Level 10	Randomly selects from patterns 2 through 10.

## SPLIT 2-2



## ALL 4

